

Installation Instructions APEX STORAGE BAG SMA-8FP13-00-00

Please read and understand the instructions completely before installation to avoid any possible injury to yourself or damage to the accessory or your snowmobile.

DEALER: These instructions contain important information for future reference and must be given to the customer.

1. PARTS LIST:

ITEM	PART NAME	DESCRIPTION	QTY.
1	INSTRUCTION SHEET	PAPER	1
2	APEX STORAGE BAG	600 DENIER POLYESTER MATERIAL	1

2. INSTALLATION:

- This bag was designed to fit under the hood between the bumper and the bulk head.
- Before using the bag loosen the bolt for the electrical box mount tilt the electrical box forward out of the way. The ground wire should be loosened and the lug carefully bent to allow it to be rotated down and away from where the bag sits. See pics. below.

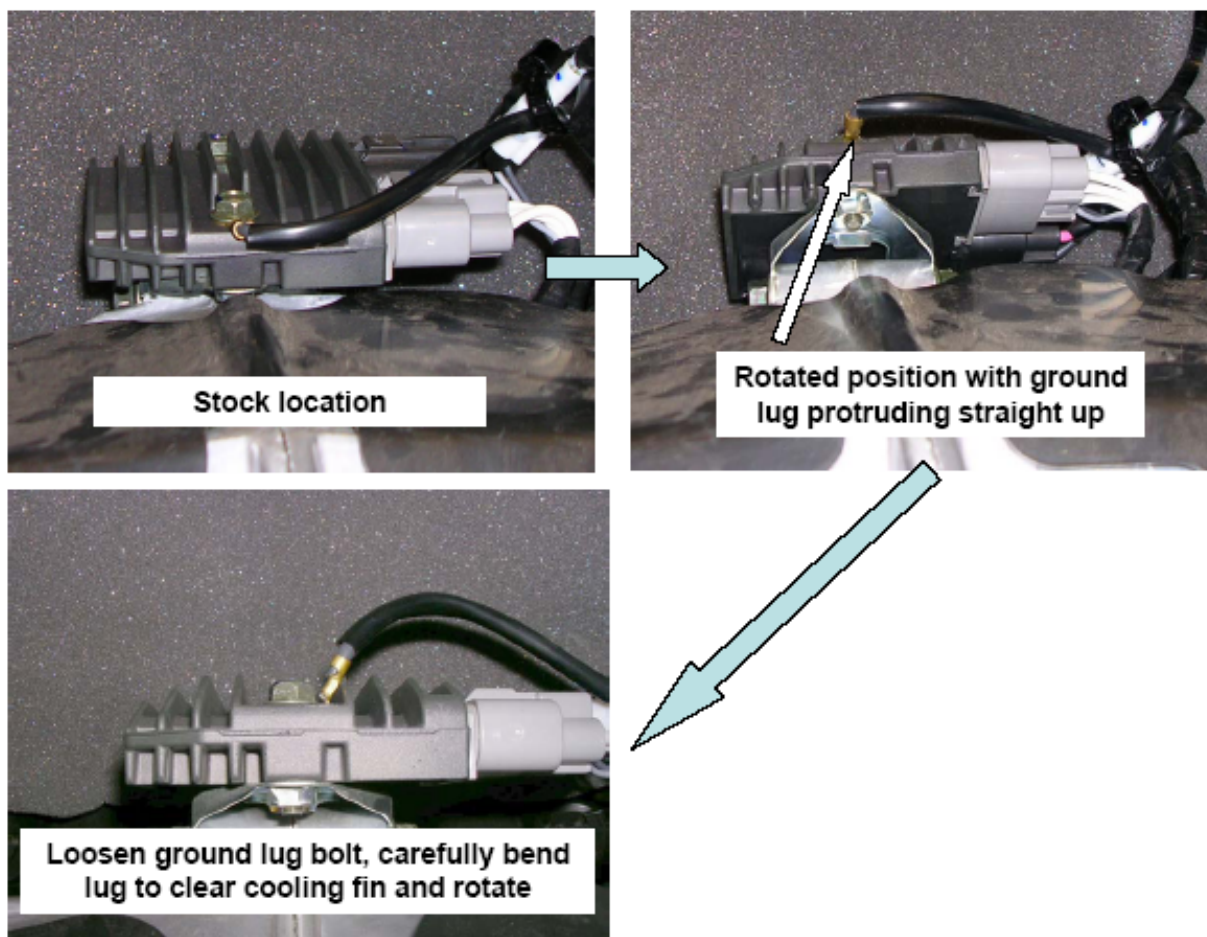

3. LOADING CONSIDERATIONS:

- NEVER OVERLOAD the storage pouch. Limit 2 lbs.
- DO NOT carry sharp, pointed or heavy objects, and distribute the load evenly.

4. CARE & CLEANING:

- Use a sponge or cloth and clean water.
- Do not use detergents or harsh chemicals.

5. CUSTOMER SERVICE: See your YAMAHA dealer.